



Installation Guide
Galley G4 Garbage Disposer
G4-WD-125

Before You Begin Installation

We are delighted you have chosen The Galley G4 Garbage Disposer for your home. This product pairs perfectly with the Ideal Deck Switch to further enhance the functionality of your Galley Workstation and WashStation™. Please read and follow this step-by-step guide for installation operation and care for this product. Doing so will ensure they are installed safely and accurately.

For your safety and a worry free installation, please read and follow ALL the instructions, cautions and warnings BEFORE installation.

WARNINGS/CAUTIONS

When using electrical appliances, the following precautions should always be taken.

1. Close supervision is necessary when the disposer is used near children.
2. Do not put hands or fingers into the disposer.
3. Turn power switch to the off position before clearing a jam or removing objects from the disposer.
4. When attempting to remove objects from the disposer, use pliers or tongs.
5. The disposer is designed for the use of normal household food waste; inserting materials other than food waste into the disposer could cause personal injury and/or property damage.
6. DO NOT pour household chemicals, solvents, paints or plastics into the disposer.
7. Keep the drain stopper in place when not in use to ensure no objects fall into the disposer.
8. DO NOT operate without the splash guard in place.
9. Regularly inspect disposer and plumbing fittings for leaks, which can cause property damage and could result in personal injury.

NOTICE

The Galley G4 Disposer is designed to operate on 110-120 Volt, 60 Hz exclusively. Do not use any other Voltage or Hz as this will adversely affect the performance of the unit while voiding the warranty. This receptacle to which the disposer is connected must be controlled by a switch. Purchase The Galley Deck Switch from your local Authorized Dealer.

Tools



PHILLIPS
SCREWDRIVER



FLATHEAD
SCREWDRIVER



ADJUSTABLE
PLIERS



HAMMER

Package Contents

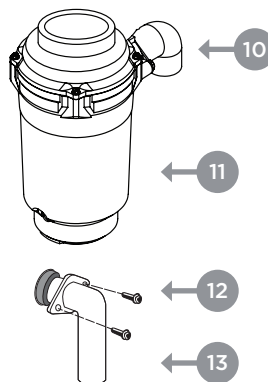
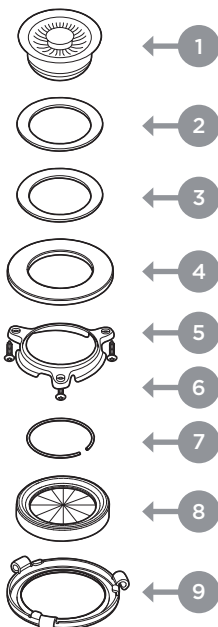

Remove all contents from the package and identify before installation.

1 - G-DRN

2 - Pex Gasket

3 - Fiber Gasket

4 - Support Flange

5 - Upper Mount Ring

6 - Mount Screws

7 - Retainer Ring

8 - Cushion Gasket/Splash Guard

9 - Lower Mount Ring

10 - Dishwasher Drain Connection

11 - Disposer Main Body

12 - Elbow Flange and Mounting Screws

13 - Waste Elbow

Removal of Existing Unit

Step 1

Before beginning this step: unplug the existing disposer from the wall and/or turn off power at the circuit/fuse box. Have a container available to catch water/waste remaining within the disposer or plumbing.

Using a pipe wrench, disconnect the drain line where it attaches to the disposer.

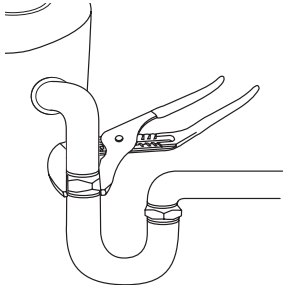

Step 2

Caution: Before performing the next step, be sure to support the disposer or it may fall when the mounting ring is disconnected from the mounting assembly.

Remove the disposer from the basin flange by turning the mounting ring to the left clockwise. If you are unable to turn the mounting ring, tap on one of the extensions on the ring with a hammer. Some mounting systems have tubular extensions allowing for the insertion of a screwdriver into one tube, providing additional leverage. In addition to this step, the loosening of the mounting screws may be necessary to fully remove the disposer.

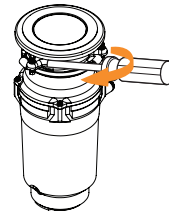

Step 3

Remove the remaining mounting system from the sink by loosening the mounting screws and pushing the mounting ring up with a screwdriver.

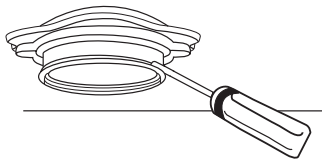

Step 4

Once removed fully, remove the flange from the top side of the basin and clean the area thoroughly in preparation for the installation of your new Galley G4 disposer.

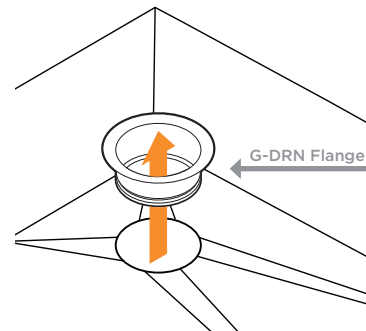

Optional Dishwasher Connection

Note: If a Dishwasher is not being installed proceed to disposer installation.

Step 1

Remove the entire plug inside the smaller stub out directly above the main drain on the body of the disposer by using a screwdriver (steel punch, dowel etc.) and hammer. Once the stopper is punched out, remove it from the interior of the disposer.

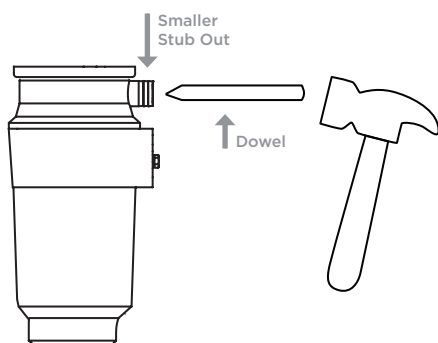

Step 2

Connect dishwasher hose to the smaller stub out using appropriate hose clamps (not provided). Make sure all plumbing connections are secure and properly fastened.

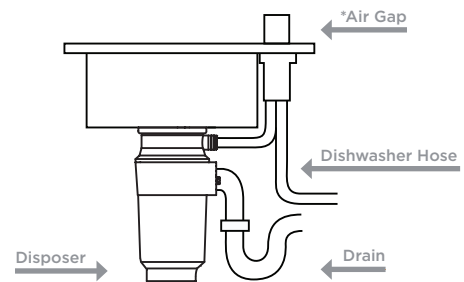

*An Air Gap may or may not be required for installation. Check with your local plumbing codes. Purchase The Galley Air Gap from your local Authorized Dealer.

G4 Disposer

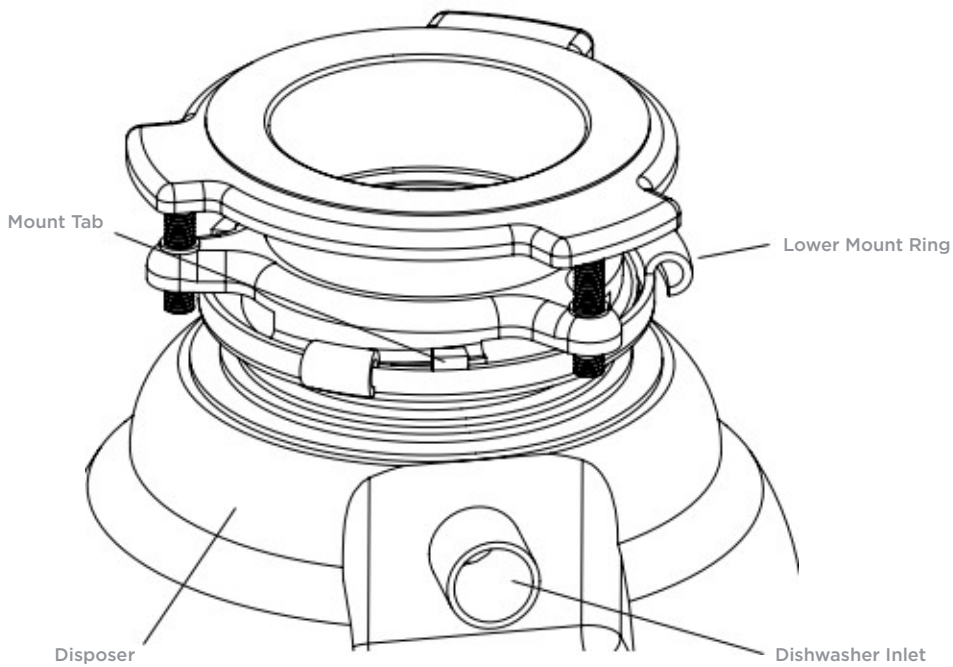

Note: The mounting assembly (see above rendering) is properly installed at the factory, please pay attention to the order of the mounting assembly when preparing for installation. This will ensure that each item is re-installed correctly.

The Cushion and Lower Mount Ring will remain attached to the disposer during installation.

G4 Disposer Installation

Step 1

Start by removing the G-DRN Flange, Pex Gasket, Fiber Gasket, Support Flange, Upper Mount Ring and Retaining Ring from the main body of the disposer and set aside. Ensure that the Cushion Gasket with built-in Splash Guard along with the Lower Mount Ring are still in place on the disposer.

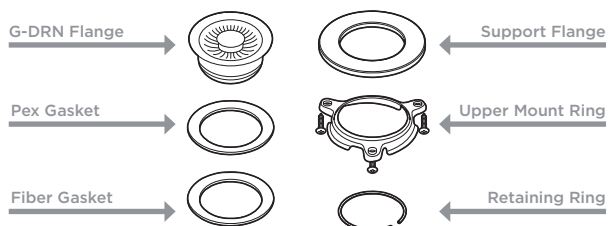

Step 2

Clean the basin drain area, then place the Pex Gasket in the drain indentation and place the G-DRN Flange into the drain hole in the basin with the Pex Gasket resting between the basin and the G-DRN Flange. This is imperative for a water tight fit. Plumbers Putty is not used on this product in ANY WAY.

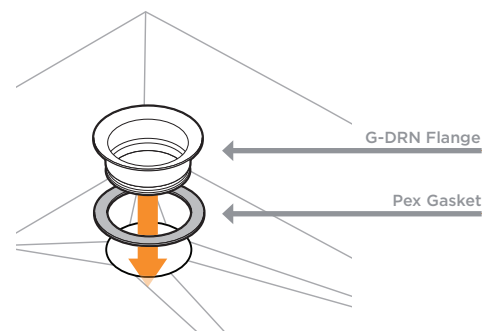

G4 Disposer Installation

Step 3

Place a heavy object on the GDRN Flange (taking care not to scratch the basin) to hold it down and in position.

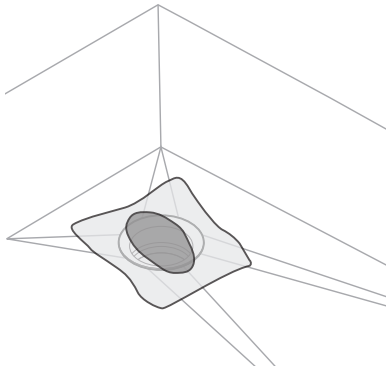

Step 4

Starting with the Fiber Gasket and Support Flange followed by the Upper Mounting Ring, place them onto the G-DRN Flange on the underside of the basin. Hold these 3 parts in place while attaching the Retaining Ring into the groove on the body of the G-DRN Flange.

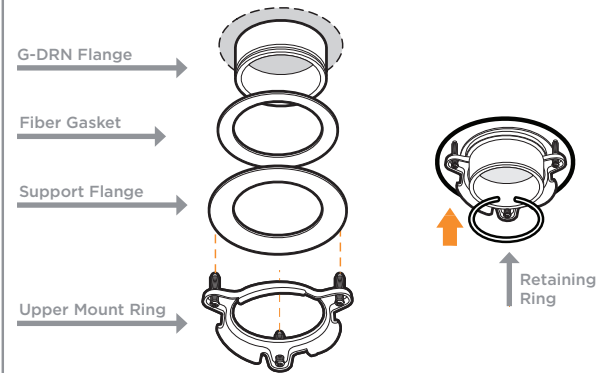

Step 5

Using a Philips screwdriver, insert and tighten the 3 Mounting Screws evenly and firmly in place against the Support Flange. Take caution to not over tighten.

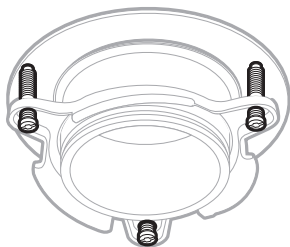

Step 6

Lifting the disposer from the bottom into place, position the disposer by aligning the 3 mounting tabs with slide-up ramps on and slightly turn the disposer counter clockwise until the discharge tube is aligned with plumbing. *Use a flathead screwdriver inserted into one of the tabs for leverage.

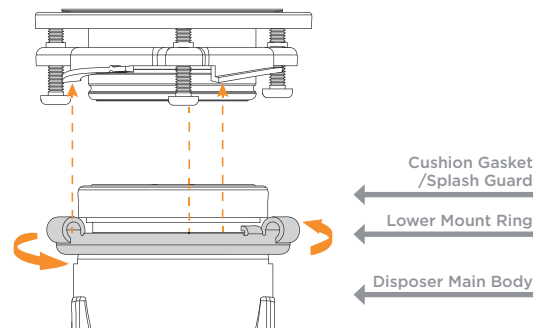

Step 7

Connect the Waste Elbow to the disposer using the supplied Elbow Flange and Mounting Screws.

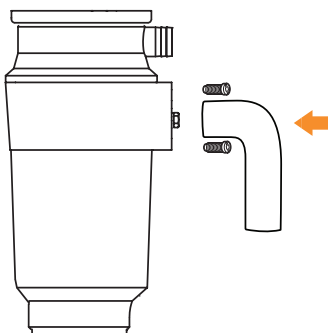

Step 8

Trim the Waste Elbow as needed to fully seat inside the existing plumbing. Fasten tightly with a Pipe Wrench. Confirm all fittings are fully seated and screws and nuts are firmly fastened before testing with water.

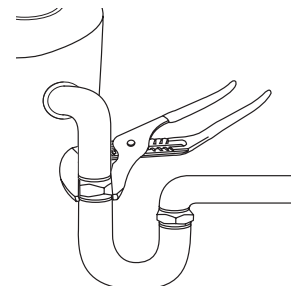

Operating Instructions

Please Note: The Galley G4 Disposer anti-jam swivel impalers make a slight clicking sound as they initially swing into place upon start up. This indicates normal operation.

1. Remove the strainer basket from the basin drain. Turn on cold water.
2. Depress deck switch to activate disposer.
3. You can now scrape food waste into your disposer. Larger bones and fibrous waste, while disposable, require considerably more grinding. Do not be alarmed when the disposer slows down while grinding in these instances. The disposer is increasing torque and is operating normally.
4. Before turning off the disposer, let water for roughly 10-15 seconds after grinding stops. This will ensure that all waste is thoroughly flushed through the drain.
5. The use of cold water is highly recommended while running the disposer as the cold water keeps waste and fats solid, enabling the disposer to flush away particles.
6. Ensure the disposer is free of waste prior to running the dishwasher to allow it to drain properly.

Maintenance

Your Galley G4 Disposer is designed and engineered to be a closed system in which the motor is permanently lubricated. **Do not attempt to lubricate your disposer.** The disposer is further self-cleaning as it scours the internal parts with each use.

Never put chemical drain cleaners into the disposer, as they can cause serious corrosion of metal parts. If chemicals are used and result in damage, they can be easily detected and **will void your warranty.**

Mineral deposits from your water can form on the interior stainless steel parts of the grinding chamber which can give the appearance of rust. This **IS NOT** rust. The stainless steel components will not corrode.

For best cleaning results, periodically clean your Galley G4 disposer by running cold water and introducing Ice cubes and cut halves of lemons into the grinding chamber. This will break up and eliminate food waste remaining in the grinding chamber left from normal use, while also freshening up the chamber by introducing natural oils from the lemon.

Troubleshooting

Please review the following steps before seeking further assistance from Customer Care.

Loud Noises: (Noises other than those that occur during grinding of small bones and fibrous food waste) These are usually caused by accidentally introducing a foreign object into the disposer's grinding chamber such as a spoon, plastic object or other foreign object(s). To correct this, turn off the disposer and water. Using tongs or another long handled tool, probe and remove the object(s) from the grinding chamber.

Disposer Will Not Start/Turn On: Unplug disposer from the Deck Switch control box. Remove the strainer basket and inspect the grinding chamber with a flashlight to ensure it is free of any foreign objects. Next, check to see if the grinding chamber turntable is functioning properly by inserting a wooden spoon handle (or similar object) and rotating the turntable clockwise. If the turntable rotates freely, check the red **reset button** on the front of the disposers main body to see if it has been tripped. Push the button until it clicks and remains depressed. Once the button is pressed, plug the disposer back in and turn on using Deck Switch.

If the turntable does not rotate freely: Turn off and unplug the disposer, carefully examine the interior of the grinding chamber, paying attention to the outer edges where small objects can become stuck and stall the turntable and stop the rotation. Dislodge any object by rotating the turntable with a wooden spoon handle (or similar object) until the object is dislodged. If no foreign object can be found, internal problems may present. **Please call customer service for further assistance.**

Leaks: If the unit leaks at the top of the disposer, it may be due to the following reasons:

1. Improper seating of the flange inside the basin drain (missing Pex gasket, not tightened enough).
2. Support ring not fully tightened or improperly installed.
3. Improperly installed cushion mount. *Remove each respective piece and go through the steps outlined in the installation portion of this installation guide. Once removed, check all components for damage.
4. If a unit leaks at the Waste Elbow, leak may be due to improper tightening of the Mounting Screws. Check screws to ensure they are tight and inspect Waste Elbow for any damage.

Replacement Parts

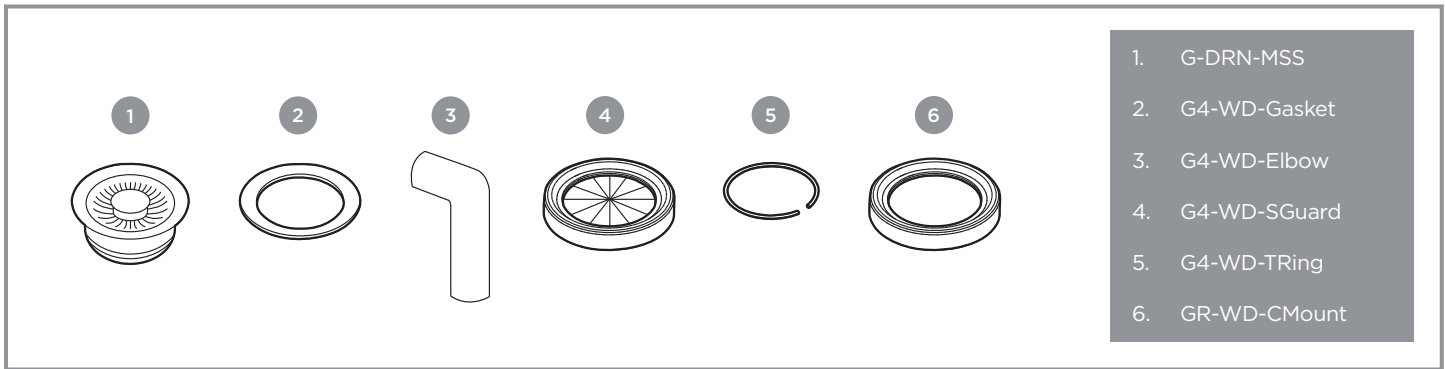

The Galley G4 Garbage Disposer - Limited Lifetime Warranty

1. GALLEY G4 GARBAGE DISPOSER TEN (10) YEAR LIMITED MECHANICAL (LIFETIME) WARRANTY —

Seller provides a Ten (10) Year Limited Mechanical Warranty for the Galley G4 Garbage Disposer. Seller warrants that the Product, when installed in a residential application following the provided installation instructions, will be free from manufacturing defects in materials and workmanship under normal usage for a period of ten (10) years from the date of purchase. Defects must be reported to the Seller within the warranty period. This Limited Mechanical Warranty is subject to the conditions and limitations outlined below.

2. WARRANTY CONDITIONS AND LIMITATIONS —

Seller's Ten (10) Year Limited Mechanical Warranty is non-transferable and strictly limited to disposers correctly installed using our installation instructions and used in a residential environment. This warranty does not cover: Damage from abuse, misuse, improper installation, or improper maintenance; failure to follow operating instructions, including running the disposal unit without water; use in a commercial or industrial setting; damage from power surges, plumbing failures, or foreign objects entering the grinding chamber; alterations, modifications, unauthorized repairs, or attempted repairs by anyone other than Seller; labor charges, removal and reinstallation expenses, freight or postage charges, or injuries resulting from a defective product; Incidental or consequential damages, including loss of use, property damage, or any related expenses.

Seller does not assume any responsibility other than to repair or replace the defective part(s) upon determining, after examination, that the Product is defective and covered by this Limited Warranty. The cost of installation, labor, and service fees, including trip charges, is not covered unless Seller has approved them in writing. Whether to repair or replace the Product is at the sole discretion of the Seller. In no event shall the liability of The Galley exceed the purchase price of the Garbage Disposer. Seller hereby disclaims all other warranties, express or implied, including but not limited to warranties of merchantability or fitness for a particular purpose, except as specifically set forth in this warranty.

Some states do not allow the exclusion or limitation of incidental or consequential damages, so certain limitations may not apply. This warranty provides specific legal rights, and you may have other rights that vary from state to state.

3. WARRANTY CLAIMS —

For claims covered by this Ten (10) Year Limited Mechanical Warranty, the defective part or Product must be returned to Seller immediately upon discovery of the material defect, but no later than the warranty period specified above. To initiate a warranty claim: Contact The Galley's customer service or your Authorized Galley Dealer. Provide proof of purchase, including a receipt with the purchase date, store, model number, and your contact information. Obtain a Return Goods Authorization (RGA) from Seller and return the defective part or Product to the original point of shipment, freight prepaid, along with the RGA form.

Seller is not responsible for shipping or transportation costs associated with returning the Product. Improper packaging or damage during return shipment may void the warranty.

These warranties are in effect for Seller's Products purchased on January 1st, 2025 and thereafter. For warranty claims, please contact your Authorized Galley Dealer or you may write to:

The Galley, LLC.
Attn: Warranty Claims
12626 South Memorial Drive
Bixby, OK 74008

Please include the original receipt with a description of the problem, model number, store, date of purchase, your name, address and telephone number.



Corporate Headquarters

The Galley, LLC.
12626 South Memorial Drive
Bixby, OK 74008
800.375.4255
thegalley.com